

Architec Built-in basin # 0318450000

| < Ø 450 mm > |

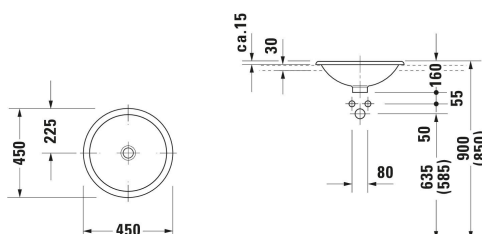

Built-in basin	Dimension	Weight	Order number
Washbasin version: Installation, 450x450 mm, Tap hole platform: No, Overflow: No, Type of mounting: counter top, Underside glazed			
Colors			
00 White Alpin			
Variant			
<input checked="" type="checkbox"/> White High Gloss	450x160 mm	6.500 kg	0318450000
Accessory			
Slotted waste washbasin without overflow, Diameter: 72 mm	Ø 72 mm	0.55 kg	005038
Suitable products			
Console vanity unit wall-mounted Number of pull-out compartments: 1, Incl. console: Yes, Tap hole drillings possible, Handle Silver, Soft self-closing automatic with damping, 800 x 550 mm	800 x 550 mm		KT6794
Console vanity unit wall-mounted Number of pull-out compartments: 1, Incl. console: Yes, Tap hole drillings possible, Handle Silver, Soft self-closing automatic with damping, 1000 x 550 mm	1000 x 550 mm		KT6795
Console vanity unit wall-mounted Number of pull-out compartments: 1, Incl. console: Yes, Tap hole drillings possible, Handle Silver, Soft self-closing automatic with damping, 1200 x 550 mm	1200 x 550 mm		KT6796
Console vanity unit wall-mounted Number of pull-out compartments: 2, Incl. console: Yes, Tap hole drillings possible, Handle Silver, Soft self-closing automatic with damping, 1400 x 550 mm	1400 x 550 mm		KT6797 B/L/R
Recommended faucets			
Single lever basin mixer L Ceramic cartridge, Height: 262 mm, Spout reach: 136 mm, Connection type for water supply connection: Flexible connecting hoses, Dimension of connection hose: 3/8", Spray mode: Normal spray, Aerator adjustable, recommended operating pressure: 1 - 5 bar, Noise class: I, 166 x 40 mm	166 x 40 mm		C11030001

<p>Single lever basin mixer XL Ceramic cartridge, Height: 322 mm, Spout reach: 166 mm, Connection type for water supply connection: Flexible connecting hoses, Dimension of connection hose: 3/8", Spray mode: Normal spray, Aerator adjustable, recommended operating pressure: 1 - 5 bar, Noise class: I, 197 x 41 mm</p>	197 x 41 mm	C11040001
<p>Single lever basin mixer Ceramic cartridge, Height: 74 mm, Connection type for water supply connection: Basic Set, Spray mode: Normal spray, Aerator adjustable, Including trim parts, recommended operating pressure: 1 - 5 bar, Noise class: I, Unified Water Label (UWL) Class: 1, 173 x 174 mm</p>	173 x 174 mm	C11070003
<p>Single lever basin mixer Ceramic cartridge, Height: 74 mm, Connection type for water supply connection: Basic Set, Spray mode: Normal spray, Aerator adjustable, Including trim parts, recommended operating pressure: 1 - 5 bar, Noise class: I, Unified Water Label (UWL) Class: 1, 173 x 225 mm</p>	173 x 225 mm	C11070004
<p>Single lever basin mixer XL Chrome, Ceramic cartridge, Height: 295 mm, Spout reach: 180 mm, Connection type for water supply connection: Flexible connecting hoses, Dimension of connection hose: 3/8", Spray mode: Normal spray, Aerator, Temperature limit adjustable, recommended operating pressure: 1 - 5 bar, Unified Water Label (UWL) Class: 1, 222 x 43 mm</p>	222 x 43 mm	A11040001
<p>Single lever basin mixer XL Chrome, Ceramic cartridge, Height: 295 mm, Spout reach: 180 mm, Connection type for water supply connection: Flexible connecting hoses, Dimension of connection hose: 3/8", Spray mode: Normal spray, Aerator, Temperature limit adjustable, recommended operating pressure: 1 - 5 bar, Unified Water Label (UWL) Class: 1, 222 x 43 mm</p>	222 x 43 mm	A11040002
<p>2 Hole basin mixer electronic XL Height: 253 mm, Spout reach: 180 mm, Temperature control: Ceramic cartridge, Aerator adjustable, Connection type for water supply connection: Flexible connecting hoses, Dimension of connection hose: 3/8", Temperature limit adjustable, Flow rate (3 bar): 5 l/min, Adjustable water run time, Hygienic flush, Spray mode: Normal spray, Incl. spout, Incl. control unit, Incl. operating unit, Operation type: Controller, without pop-up waste set, Electronic control: power supply, Protection type: IPX4, 230 x 45 mm</p>	230 x 45 mm	D11110008
<p>2 Hole basin mixer electronic XL Height: 253 mm, Spout reach: 180 mm, Temperature control: Ceramic cartridge, Aerator adjustable, Connection type for water supply connection: Flexible connecting hoses, Dimension of connection hose: 3/8", Temperature limit adjustable, Flow rate (3 bar): 5 l/min, Adjustable water run time, Hygienic flush, Spray mode: Normal spray, Incl. spout, Incl. control unit, Incl. operating unit, Operation type: Controller, without pop-up waste set, Electronic control: power supply, Protection type: IPX4, 230 x 45 mm</p>	230 x 45 mm	D11110007
<p>2 Hole basin mixer XL Height: 253 mm, Spout reach: 180 mm, Temperature control: Ceramic cartridge, Aerator adjustable, Connection type for water supply connection: Flexible connecting hoses, Dimension of connection hose: 3/8", Flow rate (3 bar): 5 l/min, Spray mode: Normal spray, Operation type: Mechanical, without pop-up waste set, 230 x 45 mm</p>	230 x 45 mm	D11130002

Architec Built-in basin # 0318450000

|< Ø 450 mm >|

2 Hole basin mixer XL Height: 253 mm, Spout reach: 180 mm,
Temperature control: Ceramic cartridge, Aerator adjustable,
Connection type for water supply connection: Flexible
connecting hoses, Dimension of connection hose: 3/8", Flow
rate (3 bar): 5 l/min, Spray mode: Normal spray, Operation
type: Mechanical, without pop-up waste set, 230 x 45 mm

230 x 45 mm

D11130009

All drawings contain the necessary measurements which are subject to standard tolerances. They are stated in mm and are non-binding. Exact measurements, in particular for customised installation scenarios, can only be taken from the finished piece.