

D-Code Whirltub # 760097000JP1000

|< 1700 mm >|

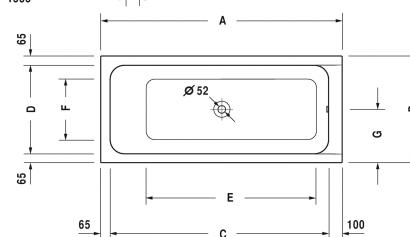
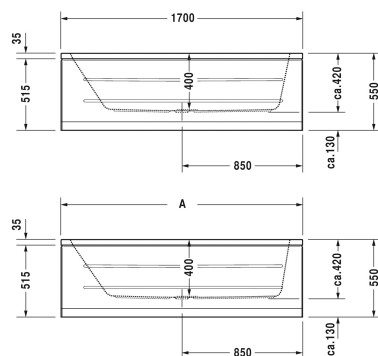
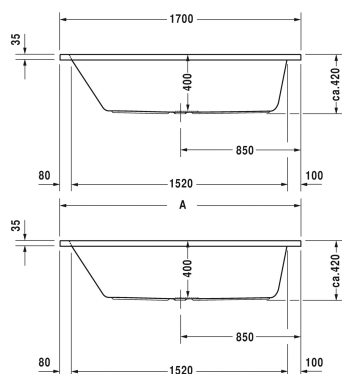
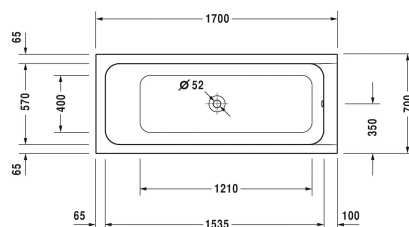

Whirltub	Dimension	Weight	Order number
rectangle, built-in, with one backrest slope, central outlet, with support frame and waste and overflow, sanitary acrylic			
Colors			
00 White Alpin			
Variant			
Jet Project	1700 x 700 mm	19.500 kilogram	760097000JP1000
Suitable setting			
Bathtub anchors for mounting and support of D-Code/D-Neo/Duravit No.1 bathtubs and D-Code shower trays, 3 pieces			790125
Suitable products			
Rubber profile for noise reduction, length: 3300 mm, Width: 70 mm,			790126
Bathtub handle for bath- and whirltubs, chrome,			792804

All drawings contain the necessary measurements which are subject to standard tolerances. They are stated in mm and are non-binding. Exact measurements, in particular for customised installation scenarios, can only be taken from the finished ceramic piece.