

**Paiova Whirltub # 760215000AS0000 / 760215000CE1000 /
760215000CL1000 / 760215000CP1000 / 760215000JS1000**

|< 1700 mm >|

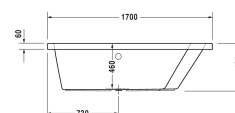
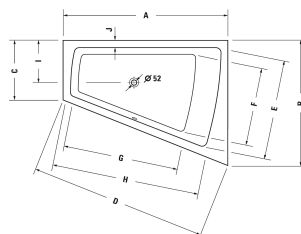
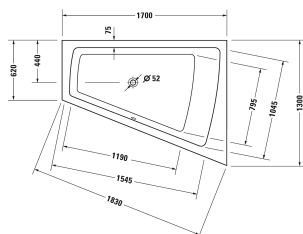
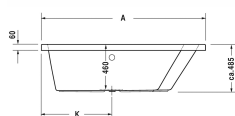

Whirltub	Dimension	Weight	Order number
with one backrest slope right, built-in, with support frame and waste and overflow, sanitary acrylic			
Colors			
00 White Alpin			
Variant			
Air-System	1700 x 1300 mm	40.000 kilogram	760215000AS0000
Combi-System E	1700 x 1300 mm	40.000 kilogram	760215000CE1000
Combi-System L	1700 x 1300 mm	40.000 kilogram	760215000CL1000
Combi-System P	1700 x 1300 mm	40.000 kilogram	760215000CP1000
Jet-System	1700 x 1300 mm	40.000 kilogram	760215000JS1000
Suitable setting for Combi-System E			
Bathtub anchors for mounting and support of bathtubs and shower trays, 3 pieces			790103
Surcharge for waste and overflow Quadroval, with base inlet, chrome, **			791231
Heating for whirltubs with Combi-System E			791882
Surcharge for waste and overflow Quadroval, with water inlet, *			791206
Suitable setting for Combi-System L			
Heating for whirltubs with Combi-System L			791883
Suitable products			
Headrest for Paiova, material: polyurethane, white,			790001
Rubber profile for noise reduction, length: 3300 mm, Width: 70 mm,			790126
Bathtub handle for bath- and whirltubs, chrome,			792804

Paiova Whirltub # 760215000AS0000 / 760215000CE1000 /
760215000CL1000 / 760215000CP1000 / 760215000JS1000

|< 1700 mm >|

All drawings contain the necessary measurements which are subject to standard tolerances. They are stated in mm and are non-binding. Exact measurements, in particular for customised installation scenarios, can only be taken from the finished ceramic piece.