

Architec Hand basin # 0766350000 / 0766350008 / 0766350009

| < 360 mm > |

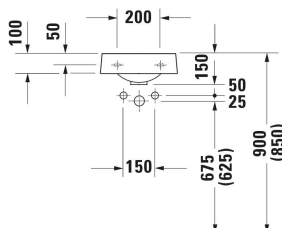
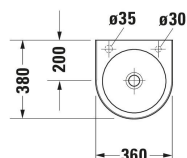

Hand basin	Dimension	Weight	Order number
Semi-circular, Tap hole platform: Yes, Overflow: No, Underside glazed, Back side glazed: No, 360 mm			
Colors			
00 White Alpin			
Variant			
● ● White High Gloss, Number of washing areas: 1 Middle, Soap dispenser position: Right, Number of pre-marked tap holes: 1	360x150 mm	7.600 kg	0766350000
● White High Gloss, Number of washing areas: 1 Middle, Number of faucet holes per wash area: 1 Right	360x150 mm	7.600 kg	0766350008
● White High Gloss, Number of washing areas: 1 Middle, Number of faucet holes per wash area: 1 Left	360x150 mm	7.600 kg	0766350009
Accessory			
Slotted waste washbasin without overflow, Diameter: 72 mm	Ø 72 mm	0.45 kg	005024
Recommended faucets			
Single lever basin mixer Ceramic cartridge, Height: 74 mm, Connection type for water supply connection: Basic Set, Spray mode: Normal spray, Aerator adjustable, Including trim parts, recommended operating pressure: 1 - 5 bar, Noise class: I, Unified Water Label (UWL) Class: 1, 173 x 174 mm	173 x 174 mm		C11070003
Single lever basin mixer S Chrome, Ceramic cartridge, Height: 155,5 mm, Spout reach: 101 mm, Connection type for water supply connection: Flexible connecting hoses, Dimension of connection hose: 3/8", Spray mode: Normal spray, Aerator adjustable, Temperature limit adjustable, recommended operating pressure: 1 - 5 bar, Noise class: I, 137 x 41 mm	137 x 41 mm		B11010002
Single lever basin mixer S Ceramic cartridge, Height: 155 mm, Spout reach: 91 mm, Connection type for water supply connection: Flexible connecting hoses, Dimension of connection hose: 3/8", Spray mode: Normal spray, Aerator adjustable, recommended operating pressure: 1 - 5 bar, Noise class: I, 121 x 40 mm	121 x 40 mm		C11010002

Architec Hand basin # 0766350000 / 0766350008 / 0766350009

|< 360 mm >|

<p>Single lever basin mixer Ceramic cartridge, Height: 74 mm, Connection type for water supply connection: Basic Set, Spray mode: Normal spray, Aerator adjustable, Including trim parts, recommended operating pressure: 1 - 5 bar, Noise class: I, Unified Water Label (UWL) Class: 1, 173 x 225 mm</p>	173 x 225 mm	C11070004
<p>Single lever basin mixer S Chrome, Ceramic cartridge, Height: 152 mm, Spout reach: 100,5 mm, Connection type for water supply connection: Flexible connecting hoses, Dimension of connection hose: 3/8", Spray mode: Normal spray, Aerator adjustable, Temperature limit adjustable, Noise class: I, 137 x 42 mm</p>	137 x 42 mm	B21010002

All drawings contain the necessary measurements which are subject to standard tolerances. They are stated in mm and are non-binding. Exact measurements, in particular for customised installation scenarios, can only be taken from the finished piece.